

Mounting instructions robinia wendy house „brevi“

Item-No. 51 8020 601

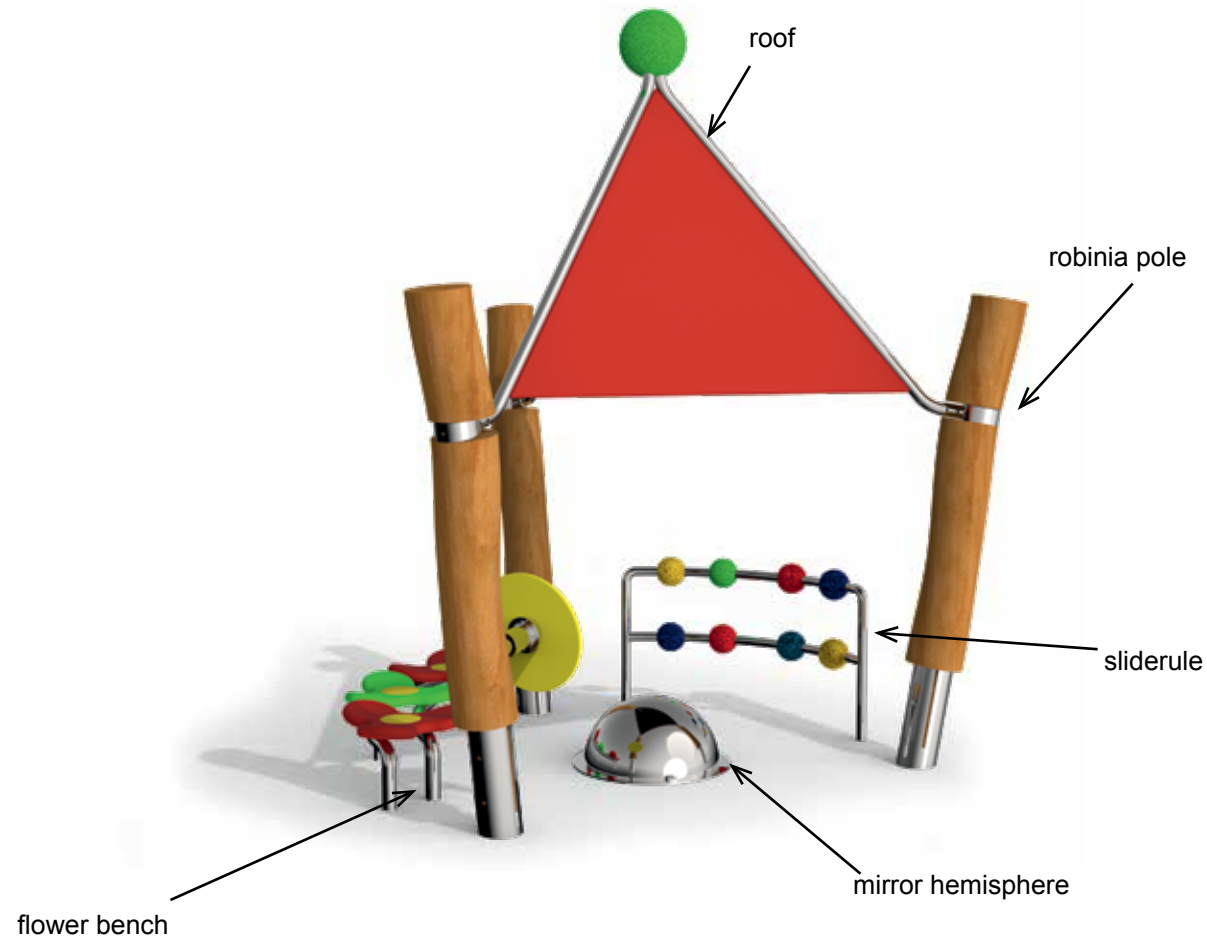

Diagram 1: Overall view of play equipment with description of individual elements

Mounting instructions robinia wendy house „brevi“

Item-No. 51 8020 601

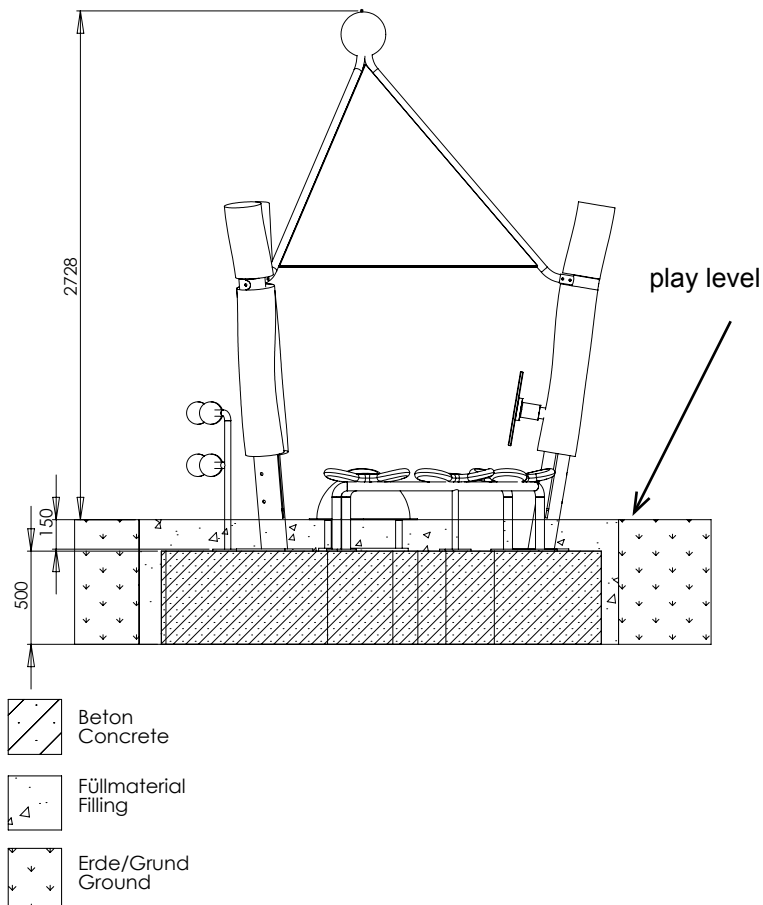

Diagram 2: Rear view with dimension details „brevi“

1. Select the play equipment location in consideration of the required safety area (see Diagram 5: Ø 5700mm).
2. Carry out excavation work for foundation as shown in Diagram 2,3 and 4. After excavation, compress the foundation floor.
Note: The combination equipment is built in on the play level. Pay attention to items marked „game level“ of play equipment!
3. Set up the three main concrete foundations (once LxWxH 1000 x 700 x 500 mm and twice LxWxH 800 x 700 x 500 mm) and the two smaller foundations (LxWxH 700 x 700 x 500 mm und LxWxH 300 x 300 x 500 mm) acc. to the dimensions indicated in diagram 2a in the quality class C 20/25.

Reinforcement plan:

Concrete foundation with reinforcement

Main foundation: BSt 500S

Ever 4 stirrups Ø 8 mm lengthwise and cross

Concrete cover $h' = 3$ cm

Concrete quality class C 20/25

Foundations for attachment parts are no-reinforced

4. After a setting period of 10-14 days, depending on weather conditions and foundation size - clean the surface of the foundations and start with the installation of the combination equipment.

Item-No. 51 8020 601

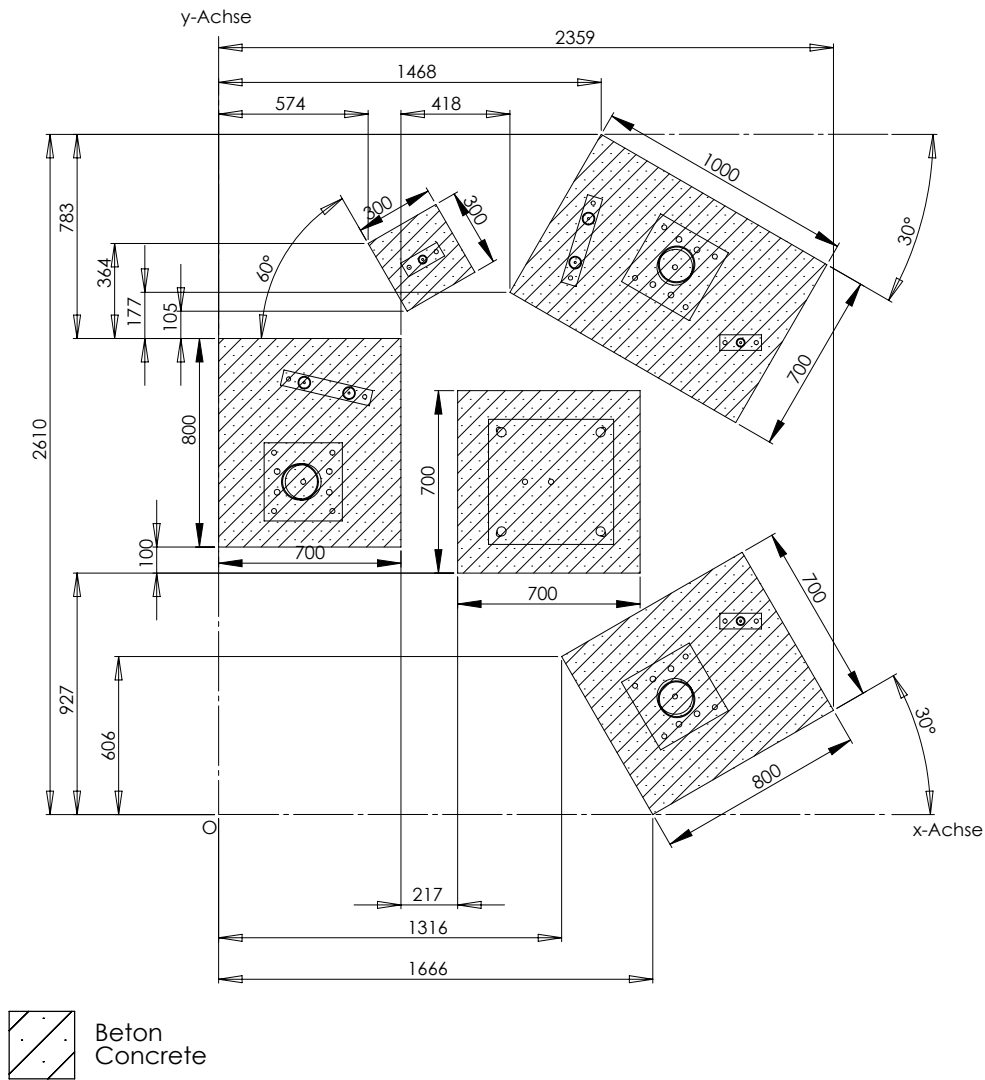

Diagram 3a: Top view of the foundation plan

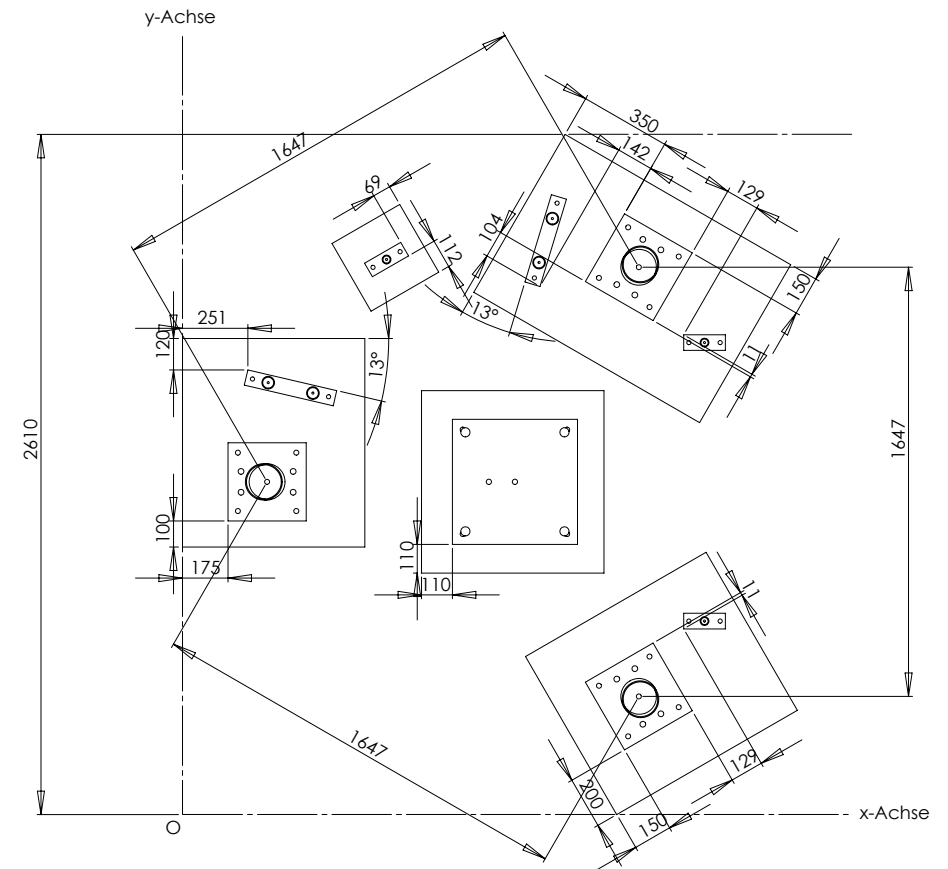

Diagram 3b: Top view of the foundation plan with the arrangement of the play house „brevi“

Mounting instructions robinia wendy house „brevi“

Item-No. 51 8020 601

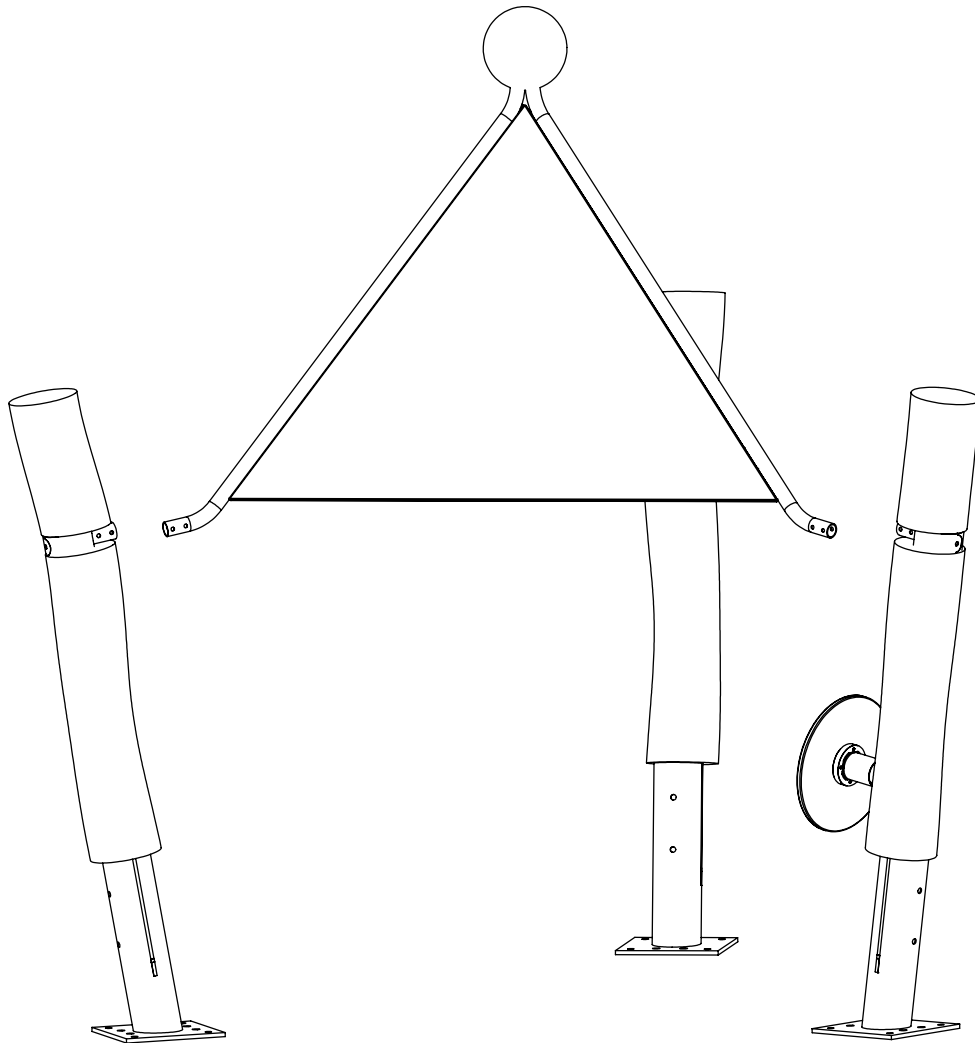

Diagram 4: assembly of the roof and robinia poles

5. Connect the roof at the intended locations acc. to the Diagram 1 and 4. with the robinia poles. Please fasten the parts using the screws including in the delivery.
6. Place the pre-assembled play house as shown in the overview and in the Diagram 3a and 3b on the main foundation and do a rough aligning. Then place the sliderule, the base plate of the mirror hemisphere and the flower bench related to the play house as shown in diagram 3b. Keep attention to the distance of the edges of the foundations.
7. Drill holes into all foundations and screw the play equipment into the foundations with the included heavy-duty dowels.
8. Seal the foundation with the safety cover required for the height of fall indicated.
Critical drop height: 0 mm.
Recommended surface material:
grass
synth. fall protection (We recommend our playpoint base with a diameter of 3,80 m, to be ordered separately)
concrete surface (The ground should be smooth and free of edges.)
9. Align the mirror hemisphere on top of the safety cover in the center of the play house and put the cover ring on the mirror hemisphere. Please fasten the parts at the base plate, using the screws including in the delivery.
10. After 3 months, check the screws at the joints and retighten them if necessary.

Mounting instructions robinia wendy house „brevi“

Item-No. 51 8020 601

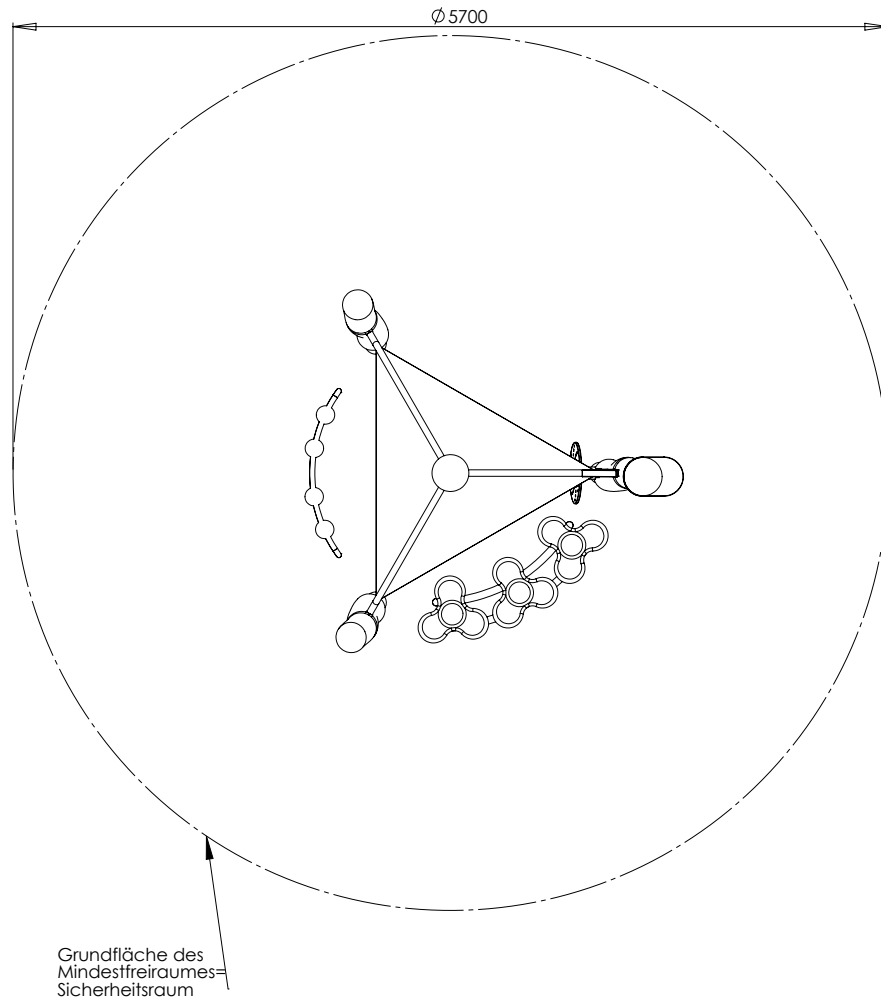

Diagram 4: safety zone

11. Do not allow children to use the equipment before the installation has been finished.

Attention: If the play equipment has been incompletely installed or partly dismantled when carrying out maintenance and repair work, this may lead to particular risks of injury for the user. For this reason, make clearly visible that the equipment shall not be used in such cases.

NOTE: Play equipment, which contain components made of stainless steel should not come with „normal“ steel parts in contact. Those steel parts may rub off and leave small steel particles in combination with moisture brown rust stains. If such corrosion occur on stainless steel parts, they are fine to remove with an abrasive (240 grit). Please take care when transporting and setting up the fact that the components are made of stainless steel with no „normal“ steel parts in contact.

Mounting instructions robinia wendy house „brevi“

Item-No. 51 8020 601

In order to preserve a good visual appearance of your stilum playground equipment over a long period one should take care of maintenance of the stainless surface even despite of their corrosion resistance. Especially areas, which can not be reached by rainfall, should be frequently cleaned from dirt and deposits due to air pollution and dirt caused by the atmosphere. Light soiling can easily be removed by using a high pressure cleaner.

For persistent deposits use a clean cloth moistened with a special liquid cleaner (e.g. on phosphoric acid) and rinse off with clear water after a short application time. During cleaning with mild abrasive components, only wipe over stainless steel surface in polishing direction. For heavily soiled surfaces, polishes can be used (e.g. for cleaning chrome on cars) or for greasy and oily dirt alcoholic cleaning agents and solvents (e.g. ethyl alcohol, isopropyl alcohol or acetone). However, it should be noted that the dissolved soiling is not spread over the surface again. Do not use any chloride or hydrochloric containing cleaning products nor scouring powder, bleaching - or silver polish cleaner. Cleaning intervals depend on type and degree of soiling as well as on demands made on optical characteristics. Therefore cleaning is advisable at intervals of six to twelve months – whereby in the case of strong soiling it is appropriate to clean the playground equipment at intervals of 3 to 6 months.