

|  |              |              |
|--|--------------|--------------|
| <b>8-sided barbecue house - Ø4,5 m</b> |              |              |
| LE no. 20072                           | MAIN DRAWING | scale : 1:75 |

|      |                   |
|------|-------------------|
| DATE | <b>28.08.2007</b> |
| REV  | A: 25.09.2008     |
| REV  | B: 06.01.2010     |

**Posts:**

- Diameter 160/180 mm Robinia

**Head and rafters:**

- 50 x 150 mm planed timber - spruce.

**Roof covering:**

- 25 mm raw Kalmar boards - larch.

Concrete required: 1 sack dry concrete / hole for posts

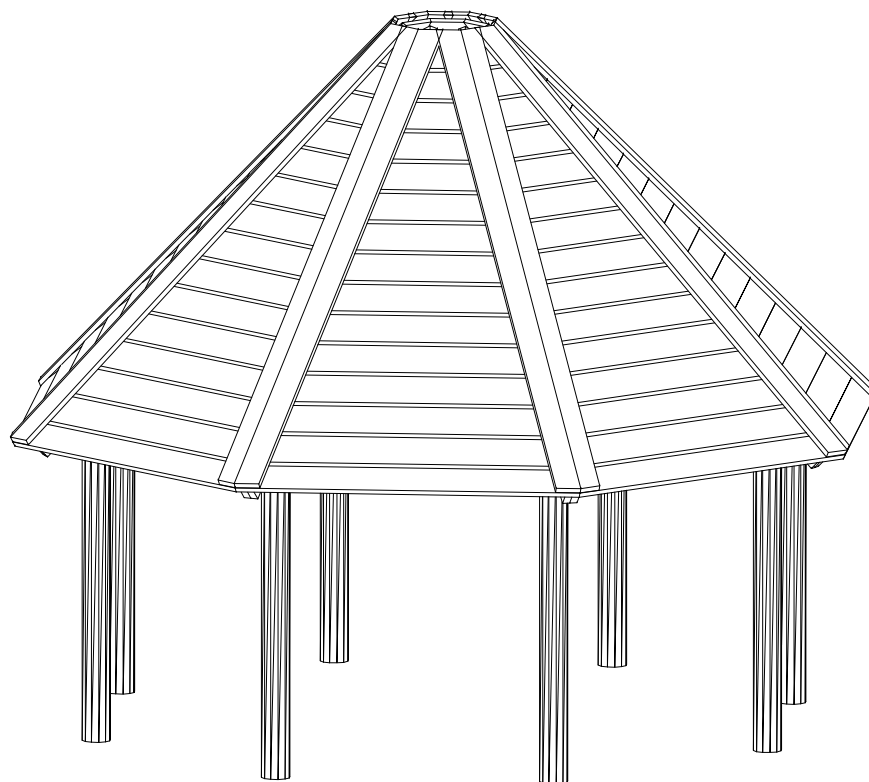

Perspective

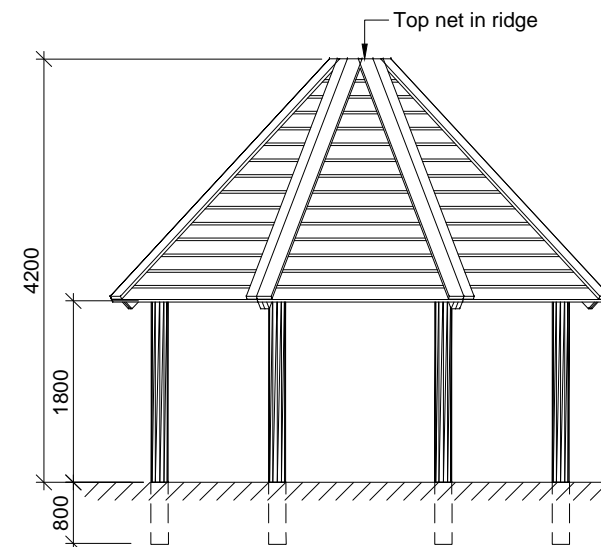

Side view

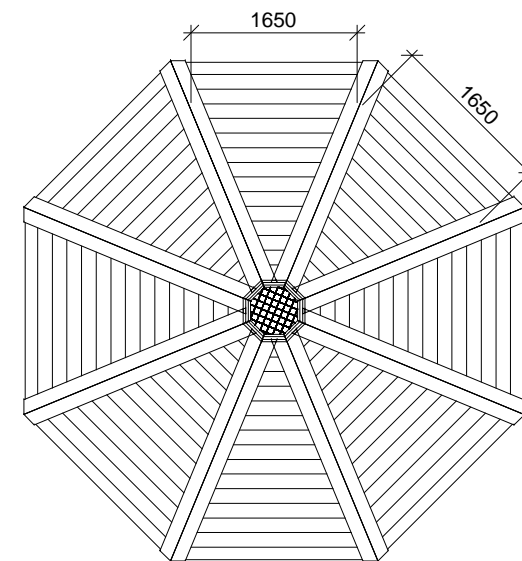

Plan