

1

2

3

4

A

B

C

D

E

F

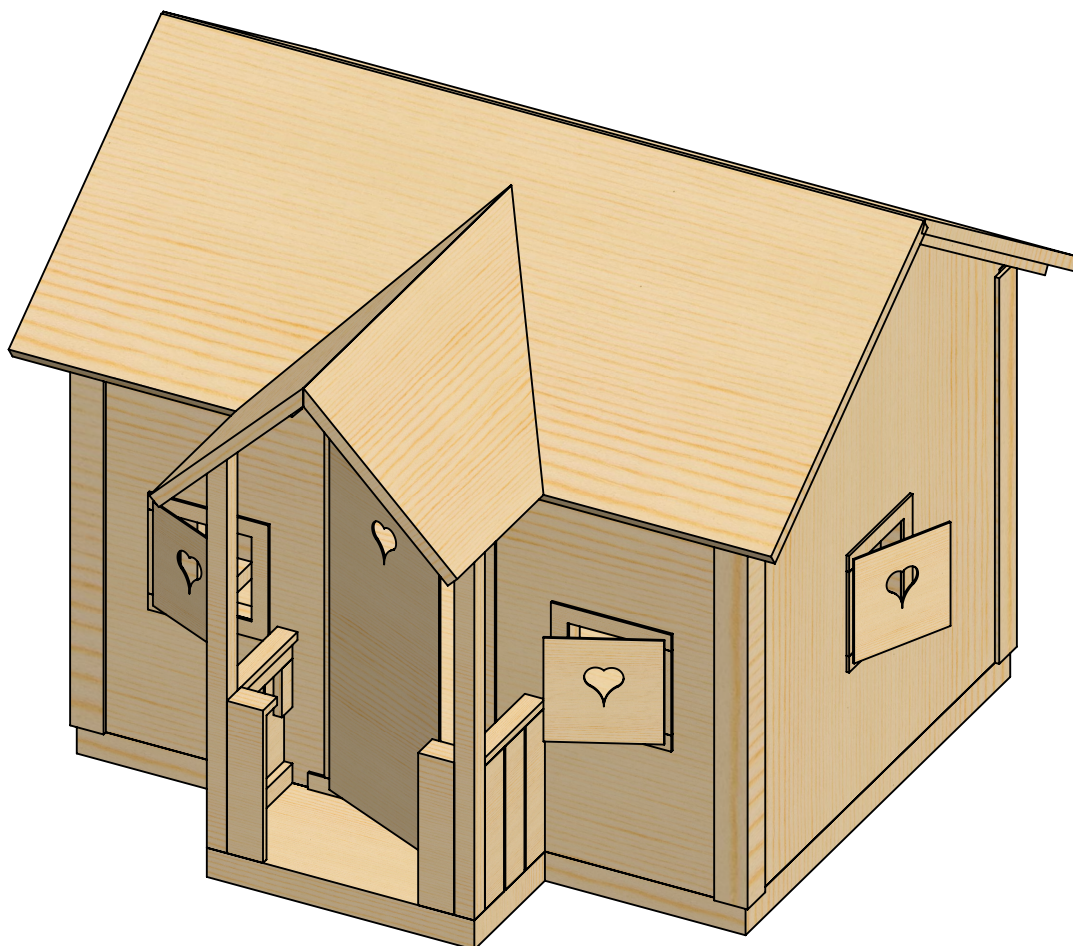

UNLESS OTHERWISE SPECIFIED:  
DIMENSIONS ARE IN MILLIMETERS  
WEIGHT ARE IN KILOGRAMM

	NAME	SIGNATURE	DATE	REVISION
DRAWN			13.04.2015	
APPV'D				

PART NUMBER / DWG NO.:

MM501

DESCRIPTION:

Large house

MATERIAL:

wood, metal, plastic

A4

WEIGHT:

SCALE: 1:30

SHEET 1 OF 11



**Tiptiptap** OÜ

Tiptiptap OÜ  
Veetorni 9,  
Jüri alevik, Rae vald,  
75301 Harjumaa

1

2

3

4

A

B

C

D

E

F

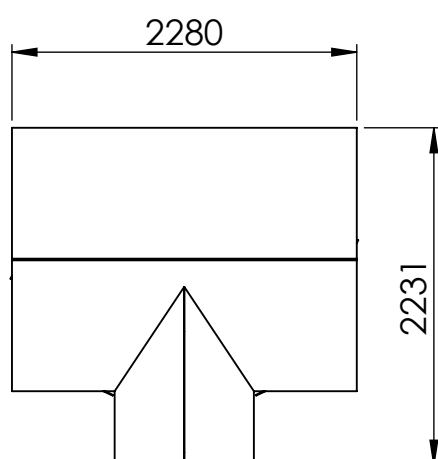
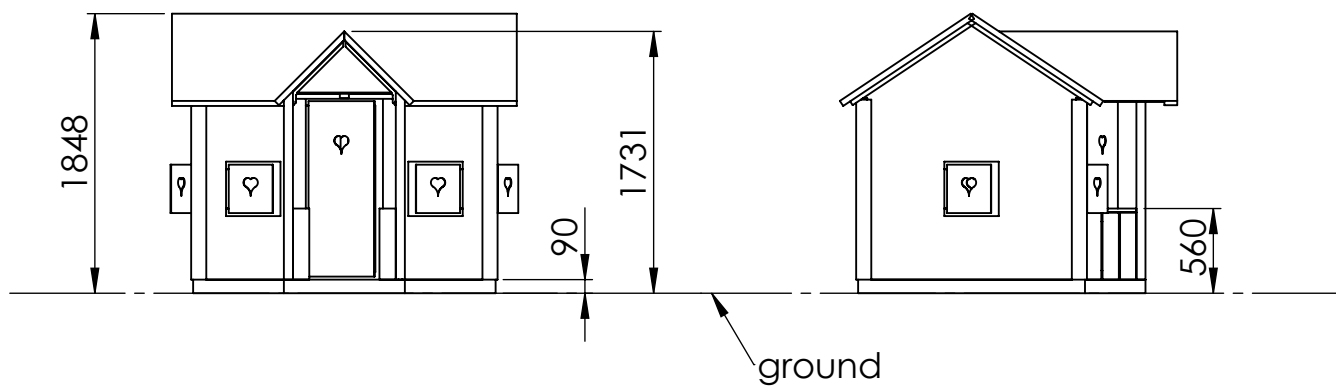

UNLESS OTHERWISE SPECIFIED:  
DIMENSIONS ARE IN MILLIMETERS  
WEIGHT ARE IN KILOGRAMM

	NAME	SIGNATURE	DATE	REVISION
DRAWN			13.04.2015	
APPV'D				

PART NUMBER / DWG NO.:

MM501

DESCRIPTION:

Large house

MATERIAL:

wood, metal, plastic

A4

WEIGHT:

SCALE: 1:30

SHEET 2 OF 11



**Tiptaptap** OÜ

Tiptaptap OÜ  
Veetorni 9,  
Jüri alevik, Rae vald,  
75301 Harjumaa

# safety area

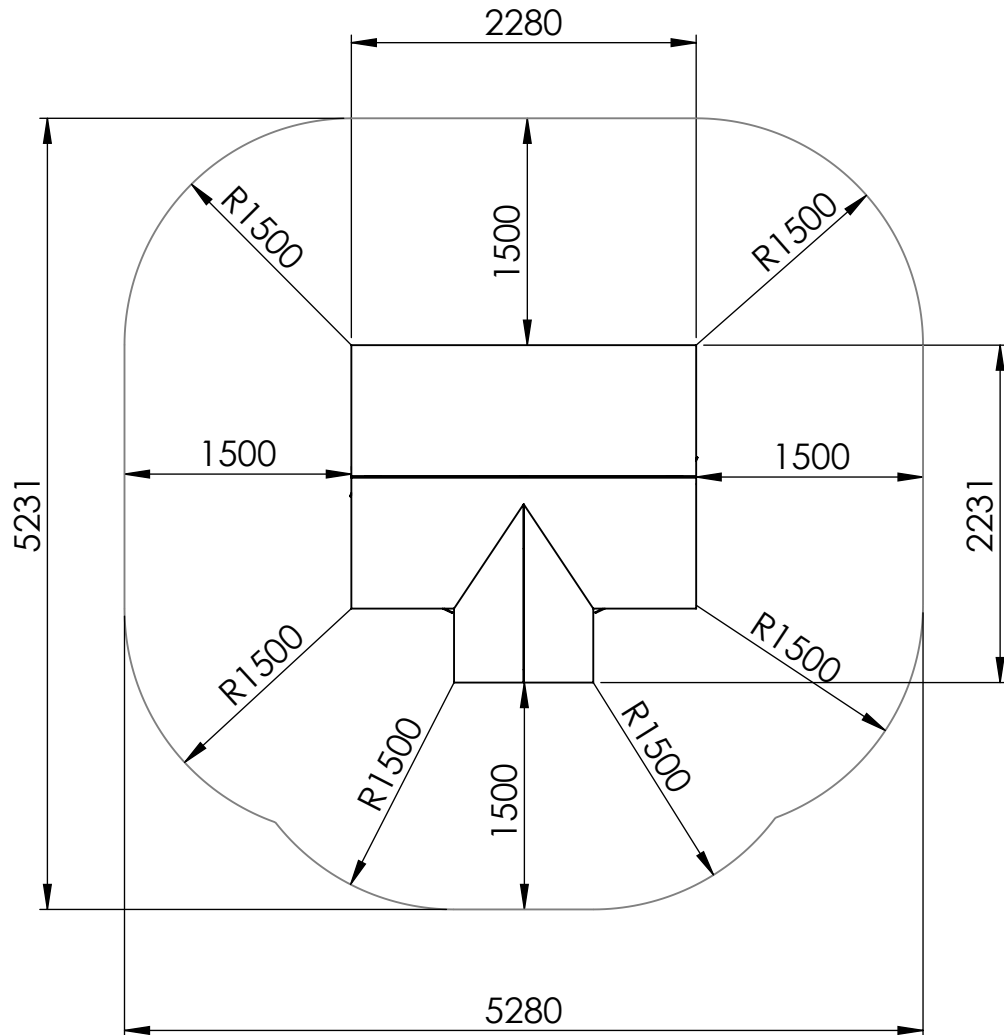

UNLESS OTHERWISE SPECIFIED:  
DIMENSIONS ARE IN MILLIMETERS  
WEIGHT ARE IN KILOGRAMM

PART NUMBER / DWG NO.:

MM501

	NAME	SIGNATURE	DATE	REVISION
DRAWN			13.04.2015	
APPV'D				

DESCRIPTION:

Large house  
safety area

MATERIAL:

wood, metal, plastic

A4

WEIGHT:

SCALE: 1:30

SHEET 3 OF 11



**Tiptaptap** OÜ

Tiptaptap OÜ  
Veetorni 9,  
Jüri alevik, Rae vald,  
75301 Harjumaa

# foundation

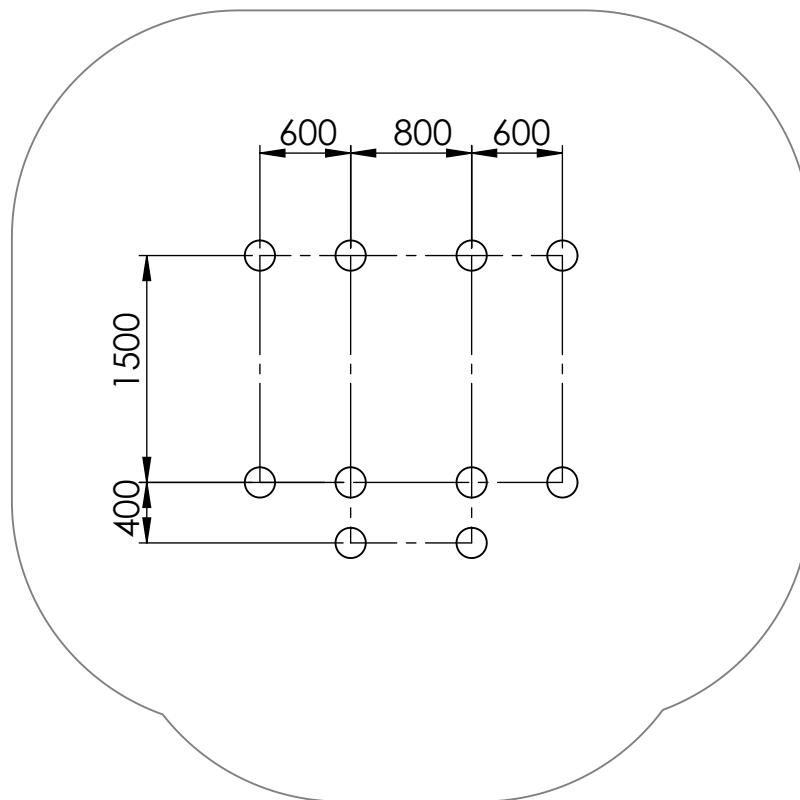

## floor fixing points on the ground

UNLESS OTHERWISE SPECIFIED:  
DIMENSIONS ARE IN MILLIMETERS  
WEIGHT ARE IN KILOGRAMM

PART NUMBER / DWG NO.:

MM501

	NAME	SIGNATURE	DATE	REVISION
DRAWN			13.04.2015	
APPV'D				

DESCRIPTION:

Large house  
foundation

MATERIAL:

wood, metal, plastic

A4

WEIGHT:

SCALE: 1:30

SHEET 4 OF 11



**Tiptiptap** OÜ

Tiptiptap OÜ  
Veetorni 9,  
Jüri alevik, Rae vald,  
75301 Harjumaa

# Step 1

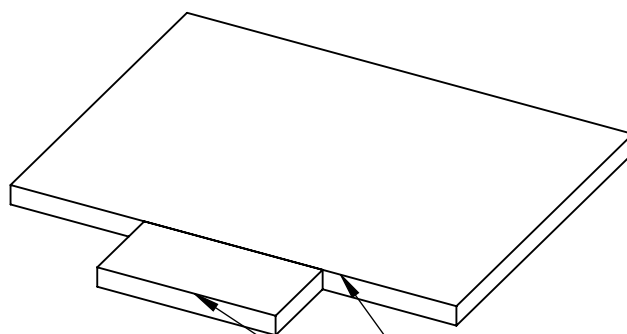

Fix the floor together  
with screws 5x90

UNLESS OTHERWISE SPECIFIED:  
DIMENSIONS ARE IN MILLIMETERS  
WEIGHT ARE IN KILOGRAMM

PART NUMBER / DWG NO.:

MM501

	NAME	SIGNATURE	DATE	REVISION
DRAWN			13.04.2015	
APPV'D				

DESCRIPTION:

Large house



**Tiptaptap** OÜ

Tiptaptap OÜ  
Veetorni 9,  
Jüri alevik, Rae vald,  
75301 Harjumaa

MATERIAL:

wood, metal, plastic

A4

WEIGHT:

SCALE: 1:30

SHEET 5 OF 11

# Step 2

Fix the corners of the walls together with screws 5x90, after that fix the wall to the floor with screws 5x90.

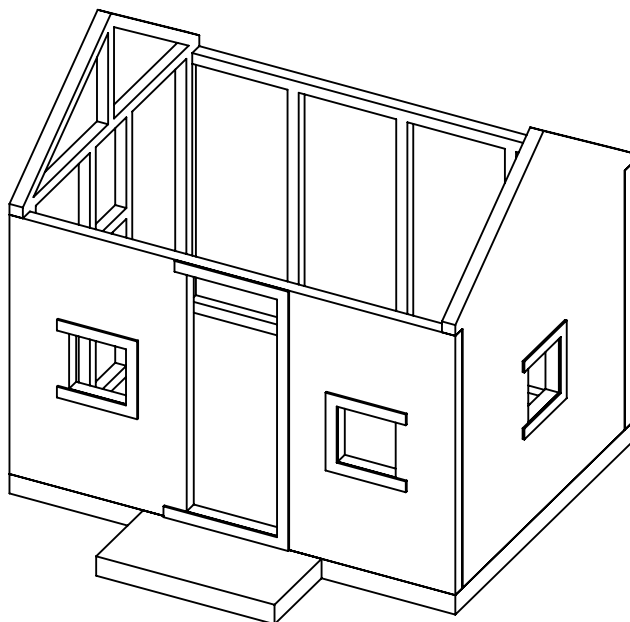
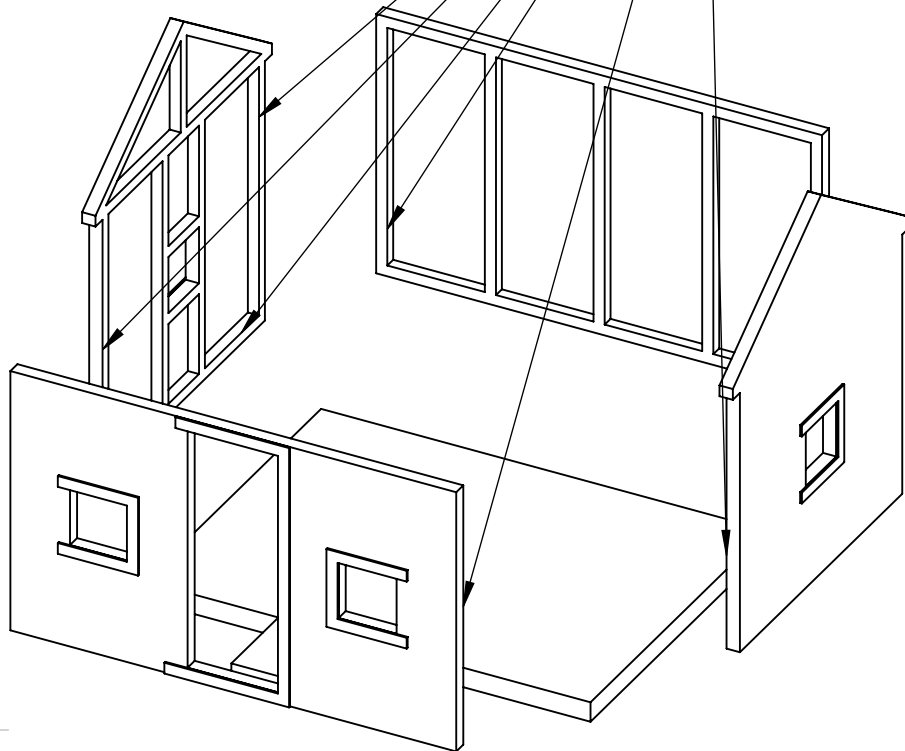

UNLESS OTHERWISE SPECIFIED:  
DIMENSIONS ARE IN MILLIMETERS  
WEIGHT ARE IN KILOGRAMM

PART NUMBER / DWG NO.:

MM501

	NAME	SIGNATURE	DATE	REVISION
DRAWN			13.04.2015	
APPV'D				

DESCRIPTION:

Large house



**Tiptaptap** OÜ

Tiptaptap OÜ  
Veetorni 9,  
Jüri alevik, Rae vald,  
75301 Harjumaa

MATERIAL:

wood, metal, plastic

A4

WEIGHT:

SCALE: 1:30

SHEET 6 OF 11

# Step 3

Fix the covers  
with screws 4,5x30

Fix the frame of the  
roof to the wall

Fix the covers  
with screws 4,5x30

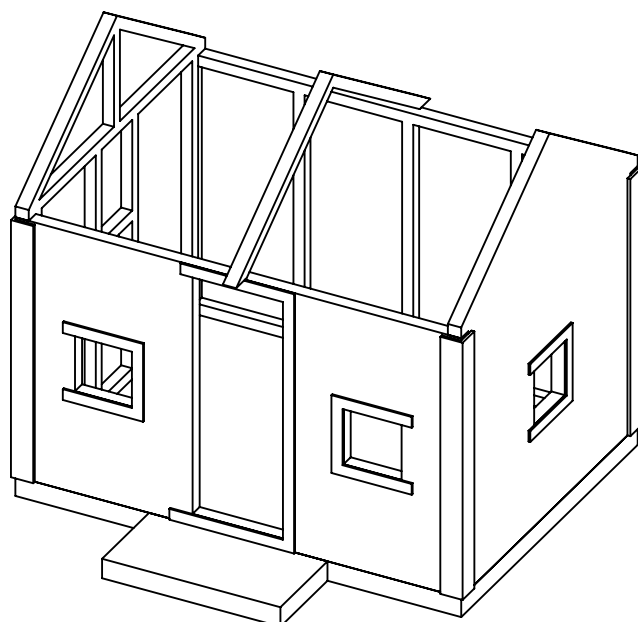

UNLESS OTHERWISE SPECIFIED:  
DIMENSIONS ARE IN MILLIMETERS  
WEIGHT ARE IN KILOGRAMM

PART NUMBER / DWG NO.:

MM501

	NAME	SIGNATURE	DATE	REVISION
DRAWN			13.04.2015	
APPV'D				

DESCRIPTION:

Large house



**Tiptiptap** OÜ

Tiptiptap OÜ  
Veetorni 9,  
Jüri alevik, Rae vald,  
75301 Harjumaa

MATERIAL:

wood, metal, plastic

A4

WEIGHT:

SCALE: 1:30

SHEET 7 OF 11

# Step 4

1. Fix the sides of the balcony to the floor and walls

2. Fix supporting beams to the sides of the balcony

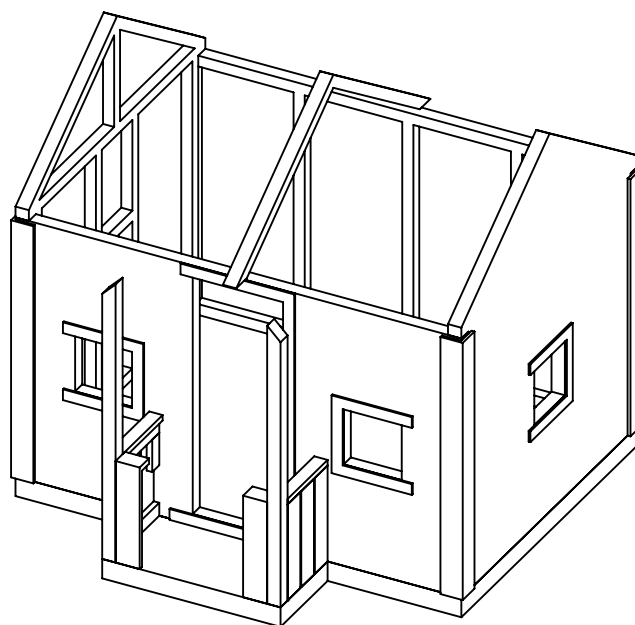
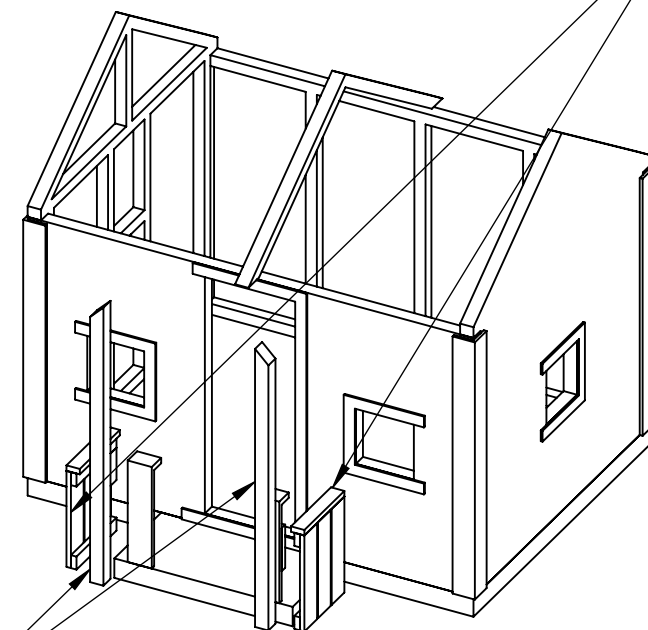

UNLESS OTHERWISE SPECIFIED:  
DIMENSIONS ARE IN MILLIMETERS  
WEIGHT ARE IN KILOGRAMM

PART NUMBER / DWG NO.:

MM501

	NAME	SIGNATURE	DATE	REVISION
DRAWN			13.04.2015	
APPV'D				

DESCRIPTION:

Large house

MATERIAL:

wood, metal, plastic

A4

WEIGHT:

SCALE: 1:30

SHEET 8 OF 11



**Tiptiptap** OÜ

Tiptiptap OÜ  
Veetorni 9,  
Jüri alevik, Rae vald,  
75301 Harjumaa



A

# Step 5

B

C

D

E

F

Fix the roof on the roof beams with screws 5x90

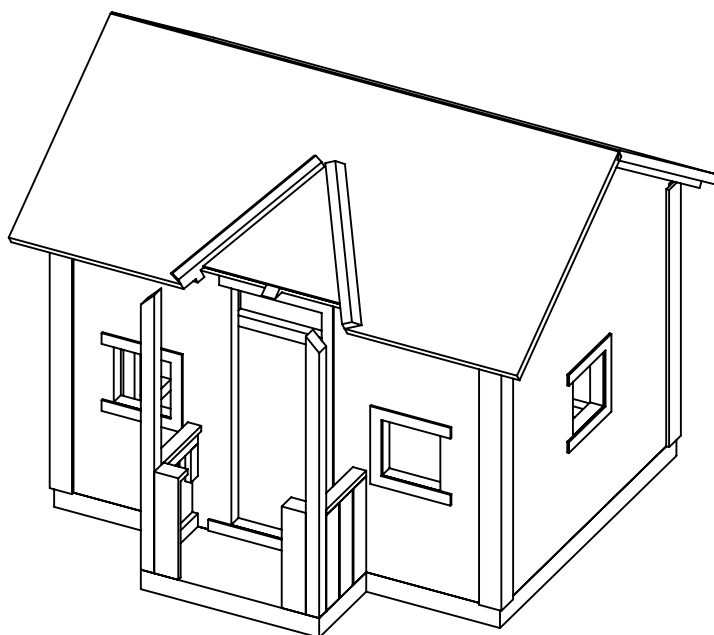
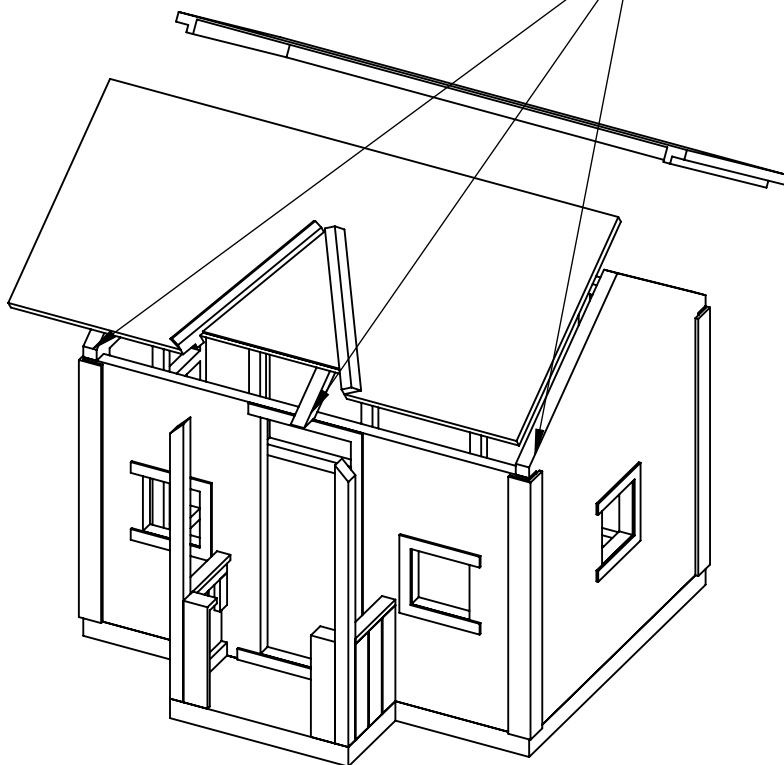

UNLESS OTHERWISE SPECIFIED:  
DIMENSIONS ARE IN MILLIMETERS  
WEIGHT ARE IN KILOGRAMM

	NAME	SIGNATURE	DATE	REVISION
DRAWN			13.04.2015	
APPV'D				

PART NUMBER / DWG NO.:

MM501

DESCRIPTION:

Large house

MATERIAL:

wood, metal, plastic

A4

WEIGHT:

SCALE: 1:30

SHEET 9 OF 11



**Tiptaptap** OÜ

Tiptaptap OÜ  
Veetorni 9,  
Jüri alevik, Rae vald,  
75301 Harjumaa

# Step 6

After fixing the main roof  
start front roof installation

Fix with screws 5x90

Fix with screws 5x90

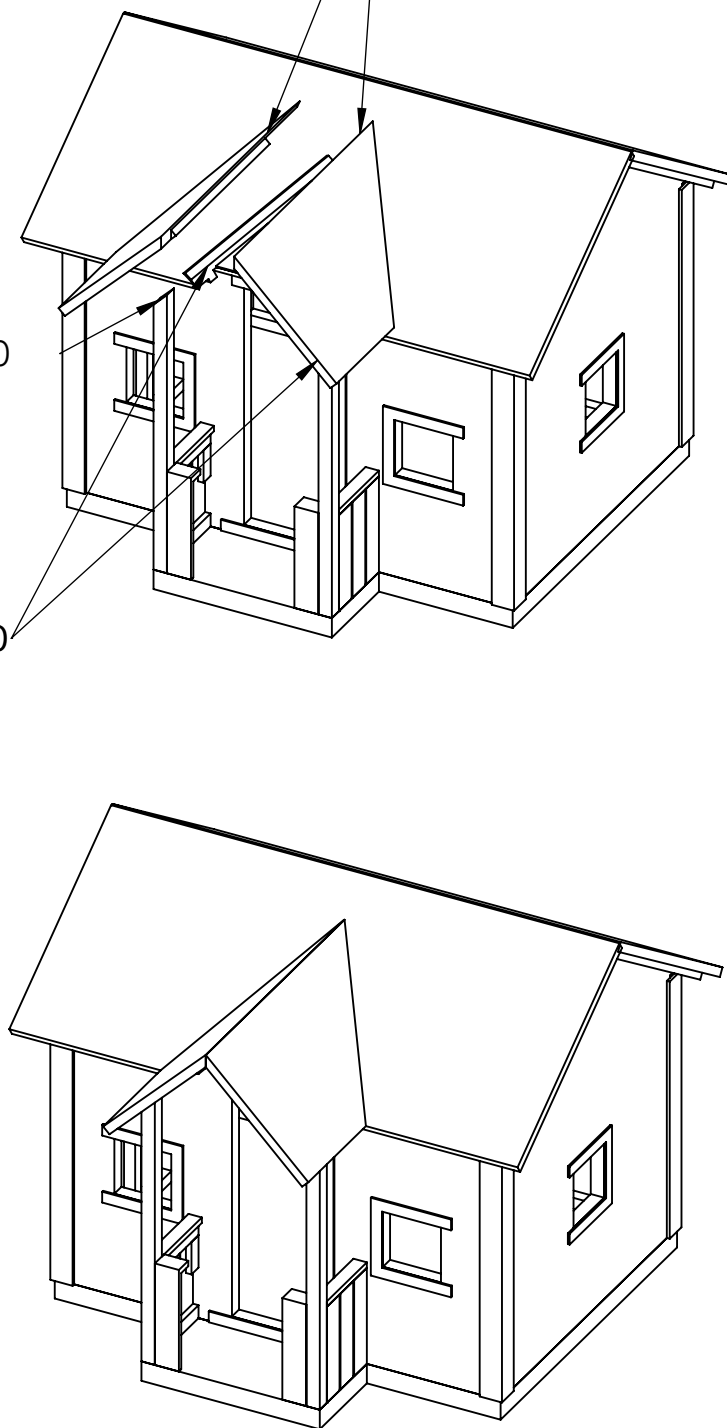

UNLESS OTHERWISE SPECIFIED:  
DIMENSIONS ARE IN MILLIMETERS  
WEIGHT ARE IN KILOGRAMM

PART NUMBER / DWG NO.:

MM501

	NAME	SIGNATURE	DATE	REVISION
DRAWN			13.04.2015	
APPV'D				

DESCRIPTION:

Large house

MATERIAL:

wood, metal, plastic

A4

WEIGHT:

SCALE: 1:30

SHEET 10 OF 11



**Tiptiptap** OÜ

Tiptiptap OÜ  
Veetorni 9,  
Jüri alevik, Rae vald,  
75301 Harjumaa

A

# Step 7

B

C

D

E

F

Fix the glass first after  
that fix the shutters

Fix the glass first after  
that fix the shutters

finally install the door

Fix the glass first after  
that fix the shutters

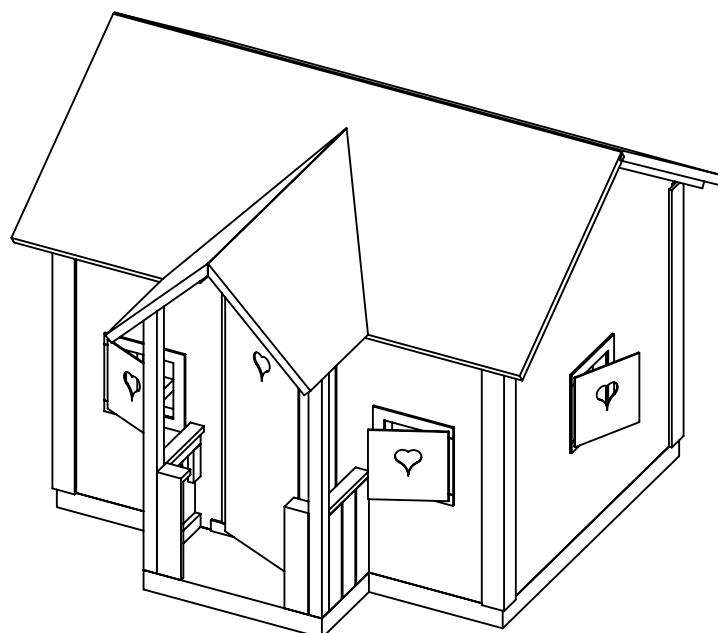

UNLESS OTHERWISE SPECIFIED:  
DIMENSIONS ARE IN MILLIMETERS  
WEIGHT ARE IN KILOGRAMM

	NAME	SIGNATURE	DATE	REVISION
DRAWN			13.04.2015	
APPV'D				

PART NUMBER / DWG NO.:

MM501

DESCRIPTION:

Large house

MATERIAL:

wood, metal, plastic

A4

WEIGHT:

SCALE: 1:30

SHEET 11 OF 11



**Tiptaptap** OÜ

Tiptaptap OÜ  
Veetorni 9,  
Jüri alevik, Rae vald,  
75301 Harjumaa